

CSM-BC400 QUICK SETUP GUIDE

NOTE: Consult the "Directions For Use" included with monitor for complete instructions, troubleshooting, and safety information

MONITOR SETUP



- 1** Attach the Velcro strap.



- 2** Open the battery compartment:
1. Install batteries
 2. If desired, set the "PAUSE" switch to "ON" (this allows patient transfer for 30 seconds without activating the alarm when pressing "RESET" button).
 3. Close the cover and secure the screw
- NOTE:** Pad life can be displayed only when PAUSE is off.



- 4** **INCREASE VOLUME:** Press and hold the "VOL" button (maximum volume is 7 bars).
DECREASE VOLUME: Press the "VOL" button, release, press again and hold (minimum is volume off)
NOTE: Volume can be turned off when a nurse call connection cable is connected.

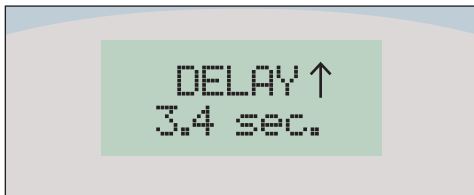

- 5** **INCREASE DELAY:** press and hold the "DELAY" button (maximum setting 4 seconds for corded and 5.5 seconds for wireless sensor pads).
DECREASE DELAY: press the "DELAY" button, release, press again, and hold (minimum setting 0 seconds for corded and 1.5 seconds for wireless pads).

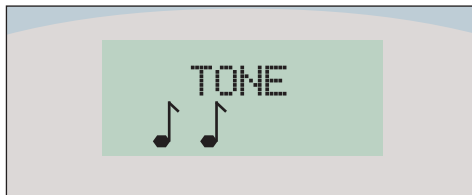

- 6** **TONE SETTING:** press and release the "TONE" button to select one of four tone options.



- 7** **NORMAL OPERATION:** Key Mode switch in up position
TAMPER-RESISTANT OPERATION: Key Mode switch in down position requires use of the override key to be placed over "KEY" icon on face of monitor in order to silence alarm and change volume, delay and tone (see the Directions for Use for full instructions).

SYNCHRONIZING ONE CORDLESS SENSOR (refer to transmitter setup)

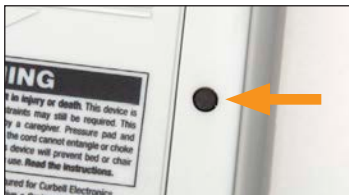

- 1** Press and hold the black programming button on the back of the monitor, until the monitor beeps three times and displays "PROGRAM MODE"
- 2** Firmly place pressure on pad and release. A long beep confirms success and the monitor will display "PAD SYNC'ED".

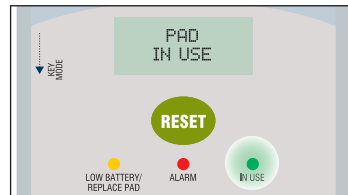
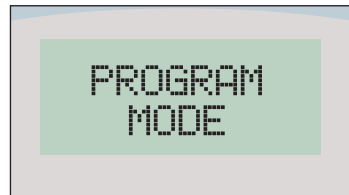

- 2** **TEST ALARM:** Put weight on the sensor pad until you hear a double beep, "PAD IN USE" is displayed, and the green LED blinks. Release weight to activate alarm.

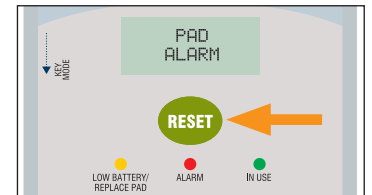

- 3** **SILENCE ALARM:** return weight to the sensor pad or press "RESET". See the Directions for Use if operating in KEY MODE.

SYNCHRONIZING A SECOND CORDLESS SENSOR

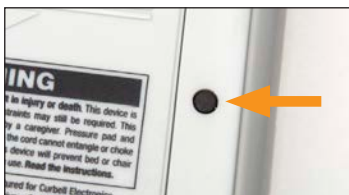

- 1** Press and hold the black programming button on the back of the monitor, until the monitor beeps three times and displays "PROGRAM MODE"
- 2** Firmly place pressure on pad and release. A long beep confirms success and the monitor will display "PAD 2 SYNC'ED".

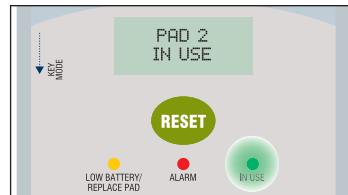
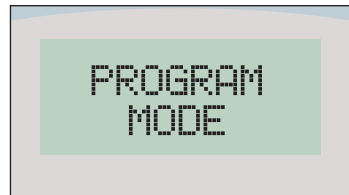

- 2** **TEST ALARM:** Put weight on the sensor pad until you hear a double beep, "PAD 2 IN USE" is displayed, and the green LED blinks. Release weight to activate alarm.

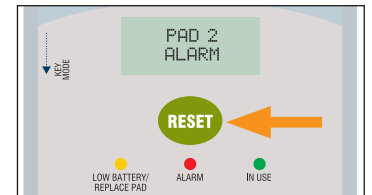

- 3** **SILENCE ALARM:** return weight to the sensor pad or press "RESET". See Directions for Use if operating in KEY MODE.

UNSYNCHRONIZE THE MONITOR AND PAD

NOTE: No weight can be on the sensor pad when unsynchronizing the monitor and pad.

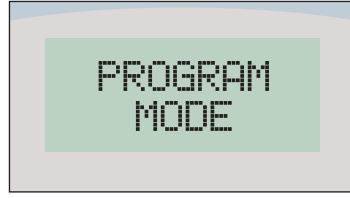
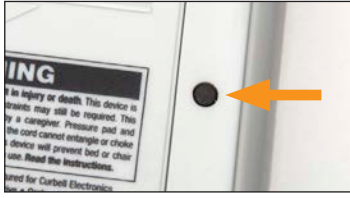

- 1 Press and hold the black programming button on the back of the monitor, until the monitor beeps three times and displays "PROGRAM MODE" or "PROGRAM FULL"

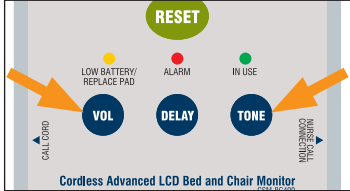

- 2 Press and hold the VOL and TONE buttons simultaneously until the monitor beeps and the display reads "ALL PADS ERASED"

CORDED SENSOR USE

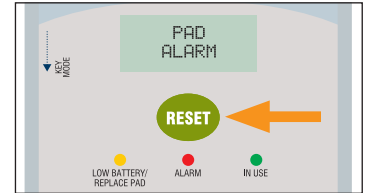
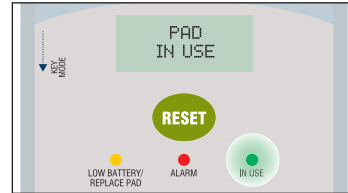

- 1 **CORDED PAD CONNECTION:** Wrap the sensor pad cord around "STRAIN RELIEF", and then connect to "SENSOR PAD" receptacle on monitor.

- 2 The monitor will display "PAD CONNECTED".
NOTE: When a corded pad is connected, cordless pads will not function.

- 3 **TEST ALARM:** Put weight on the sensor pad until you hear a double beep, "PAD IN USE" is displayed, and the green LED blinks. Release weight to activate alarm.

- 3 **SILENCE ALARM:** return weight to the sensor pad or press "RESET". See the Directions for Use if operating in KEY MODE.

SETTING UP THE SYSTEM

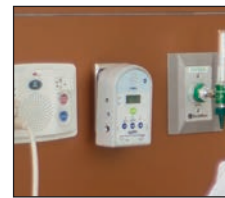

- 1 Write in the appropriate date(s) on the sensor pad

- 2 **SECURE THE MONITOR** to the back of the patient's chair, bed, or wall and (if applicable) connect the AC power cord and plug it into the room power receptacle.

- 3 **POSITION THE SENSOR PAD** on the chair or bed as instructed/illustrated on the pad.

CONNECTING TO NURSE CALL AND A CALL CORD

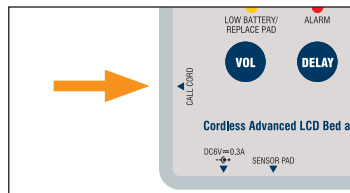
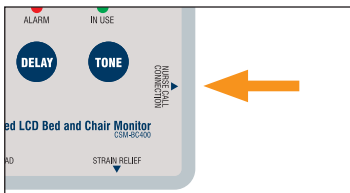

NURSE CALL: Plug a nurse call connection cable into the "NURSE CALL" jack, connect the opposite end of the cable into the Nurse Call Station (an adaptor may be required) and test.

CALL CORD: If using a call cord, plug it into the "CALL CORD" jack in the monitor and test.*

BC400 TROUBLESHOOTING CHECKLIST

This checklist has been developed to help identify common issues that can be quickly addressed to prevent unnecessary product returns. Please also refer to the product's Directions for Use and instructional video on Curbell's website (www.curbellmedical.com). If, after completing the checklist, the product continues to malfunction, please call your Curbell Representative at 888-222-2188.



No power/green “in use” light does not blink

- Batteries are installed according to the diagram in the battery compartment.
- Batteries are fresh and/or known to be good.

If an AC adapter being used:

- The connection between the monitor and the AC outlet is secure and not damaged.
- The outlet in use is functioning properly and not controlled by a light switch.

LCD displays “LOW BATTERY” or “REPLACE BATTERY”

- Replace all batteries with new Energizer Industrial (or equivalent) batteries.

Wireless sensor pad does not synchronize to the monitor

- The transmitter in the sensor pad is securely connected with no visible cord or connector damage.
- The transmitter's ON/OFF switch has been permanently turned ON. The red STATUS/IN USE light on the transmitter blinks approximately every 30 seconds.
- No part of the pad/mat (including in the neck of the sensor) is folded and/or creased.
- The sensor is in a flat position on a flat surface with no heavy blanket, gel, or foam interfering.
- The pad is within 30 feet of the monitor.
- The transmitter and transmitter antenna are properly connected and positioned to maximize range and performance (see figure 1).
- Reset the monitor by unsynchronizing the sensor and monitor and then resynchronize them.
- A corded sensor pad is not plugged into the monitor..
- If the monitor is in the KEY MODE (the switch on the side of the monitor is down), the RESET button will not work unless first using the override key, or sliding the KEY MODE switch to the up position.

figure 1

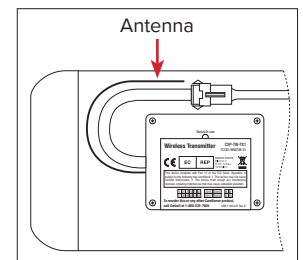

Reset button does not cancel the alarm

- If the monitor is in the KEY MODE (the switch on the side of the monitor is down), the RESET button will not work unless first using the override key, or sliding the KEY MODE switch to the up position.

No alert is given to the facility's nurse call system

- The connection between the monitor and the nurse call patient station is securely connected and not damaged (a 1/4" mono nurse call jack and/or an adaptor for compatibility is required).
- The connection cable is connected to the monitor's 1/4" "NURSE CALL CONNECTION" jack.

False alarm or no alarm sound occurs

- The pad is placed properly on the chair or bed.
- No part of the pad/mat (including the neck of the pad) is folded and/or creased.
- The pad/mat has not expired.
- There is no heavy blanket, gel, or foam cushion on the pad that may interfere with proper operation or cause delay in the alarm.
- The volume level has been turned up.
- The PAUSE switch located in the battery compartment is not turned on. If it's in the ON position, when the RESET button is pressed, the monitor is programmed to not alarm for 30 seconds, and the display will show "PAUSE".

If a Corded Sensor Pad is being used:

- The cord between the monitor and sensor is securely connected and not damaged.
- The breakaway cord connector has been pushed in fully until it clicks.

Lost Signal Alert

- The sensor pad is within 30 foot unobstructed range of the monitor.
- The transmitter in pocket has not been turned off and the red status in-use light flashes approximately every 30 seconds.
- The patient is not lying or sitting directly on the sensor transmitter.
- The transmitter and transmitter antenna are set up properly as illustrated in figure 2.
- Rubber bands and clips are used to secure the bed sensor pad to the bed so the sensor is properly positioned under the buttocks area and the transmitter hangs off the side of mattress, preferably on the same side of bed/room as the monitor.
- No walls or metal objects are between the pad and monitor.

NOTE: Best performance and range is achieved by proper placement of transmitter and antenna in sensor pocket as illustrated in figure 2 and the monitor is installed facing the transmitter as close together as possible (see figure 3). Many structural factors like metal, body mass, and other construction materials can, and in some cases, dramatically reduce range and performance. As a final check, try moving the monitor closer to the pad and re-test.

figure 2

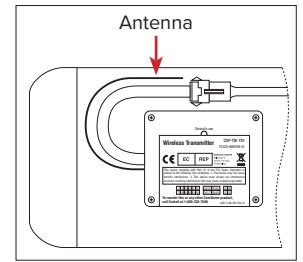

figure 3

